

Pairing your Nathos Nova Hearing Aid to a Bluetooth® enabled device

Initial Pairing

1 On your device (e.g. a phone), ensure that Bluetooth wireless technology is enabled and search for Bluetooth enabled devices in the connectivity setting menu.

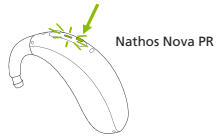

2 Switch both hearing aids off, and on again. You now have 3 minutes to pair your hearing aids with your device.

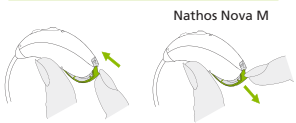

3 Your device shows a list of Bluetooth enabled devices. At this stage you will only see one hearing aid, continue and select the hearing aid from the list. This will simultaneously pair both hearing aids to your phone. A beep confirms successful pairing.

After your hearing aids have been paired to your device, they will automatically connect again when switched on.

Phone calls

Your hearing aids connect directly with Bluetooth® enabled phones. When paired and connected to your phone, you will hear

the caller's voice directly in your hearing aids.

Your hearing aids pick up your voice through its own microphones. You can accept, end and reject calls directly on your phone or via your hearing aids (see below)

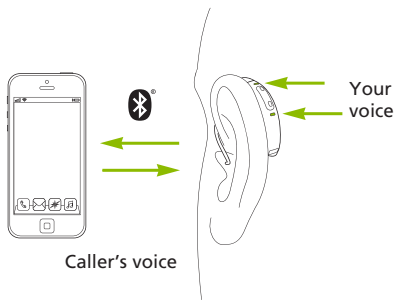

Accepting, ending and rejecting a call

A call can be accepted by a short press on the upper or lower part of the multi-function button

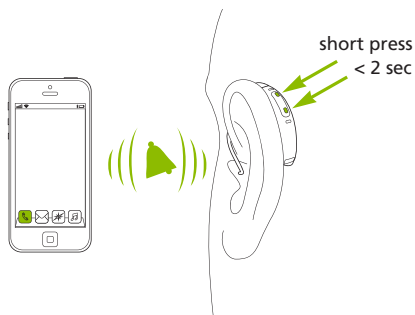

A call can be ended by a long press on the upper or lower part of the multi-function button



An incoming call can be rejected by a long press on the upper or lower part of the multi-function button

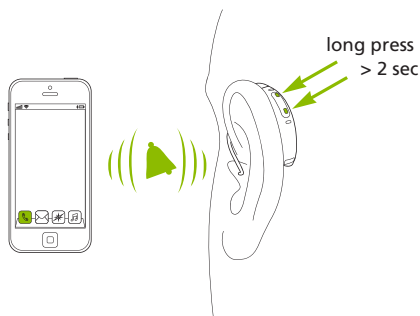

MyPhonak App

Your Audiologist may recommend you connect your Hearing Aid to the myPhonak app to give you access to select, adjust and save existing hearing aid functions as well as access to Remote Support appointments with your Audiologist.