

## HELP REDUCE BLOODSTREAM INFECTION

### Peripheral Venous Catheter – Adult in-patients

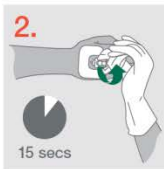

Skin is cleansed with an antiseptic containing 2% Chlorhexidine 70% Isopropyl alcohol and left to dry before PVC insertion.



Access should be via the needlefree connector, not the port at the top of the device. Before accessing this you should “scrub the hub” for at least 15 seconds with a 2% Chlorhexidine 70% Isopropyl alcohol wipe.

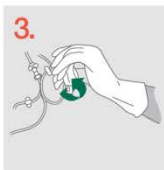

A single or multi-lumen needlefree connector must be primed with 0.9% normal saline before attaching to PVC.



A PVC care plan should commence as soon as possible after PVC insertion and the PVC must be checked at least once per day. The care plan must be fully completed to ensure optimal practice and to avoid patient harm.