

NHS Greater Glasgow & Clyde

# 2016/17 Annual Review

2<sup>nd</sup> October 2017



# 2016/17 Annual Review

## Scottish Government

- **Shona Robison**  
*Cabinet Secretary for Health and Sport*
- **Paul Gray**  
*Director General Health and Social Care and Chief Executive NHS Scotland*
- **Alan Hunter**  
*Director of Performance and Delivery*
- **Christine McLaughlin**  
*Director for Health Finance*
- **Alison Taylor**  
*Head of Integration*

## NHS Greater Glasgow & Clyde

- **John Brown CBE**  
*Chairman*
- **Jane Grant**  
*Chief Executive*
- **Dr Jennifer Armstrong**  
*Medical Director*
- **Dr Margaret McGuire**  
*Nurse Director*
- **Mark White**  
*Finance Director*
- **Dr Linda de Caestecker**  
*Director of Public Health*

# 2016/17 Annual Review

## Today's Structure

- Key Achievements and Challenges
- Look Ahead
- Questions and Answers



# 2016/17 Annual Review

## Themes

- Person Centred
- Safe
- Effective



# 2016/17 Annual Review

## Person Centred

- Person Centred means providing healthcare in partnership with people using our services
- Working in partnership with service users
- Person-Centred Health and Care Programme

# 2016/17 Annual Review

## Person Centred

- Tackling Inequalities
- Listening to our patients, carers and relatives:
  - Extended our visiting times
  - Created new menu's



# 2016/17 Annual Review

## Safe

### *Key Achievements:*

- Scottish Patient Safety Programme
- Infection Control Compliance
- Hand Hygiene Compliance



# 2016/17 Annual Review

## Safe

### *Challenges:*

- Hospital and Community Acquired Infections
- Healthcare Environment Inspections
- Older People In Acute Hospitals





# 2016/17 Annual Review

## Effective

### *Key Achievements:*

- Public Health
- Child and Adolescent Mental Health
- Antenatal Care
- 18 week Referral To Treatment
- IVF Treatment
- Financial Balance
- Capital Investment Programme



# 2016/17 Annual Review

## Effective

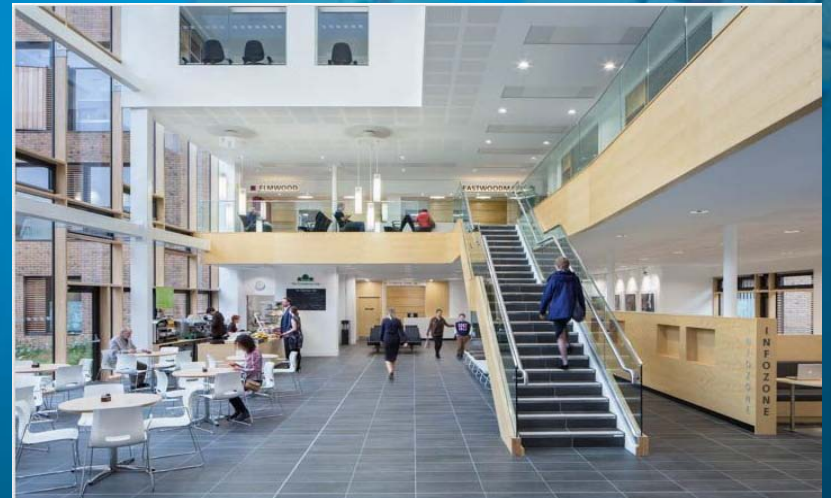

# 2016/17 Annual Review

## Effective

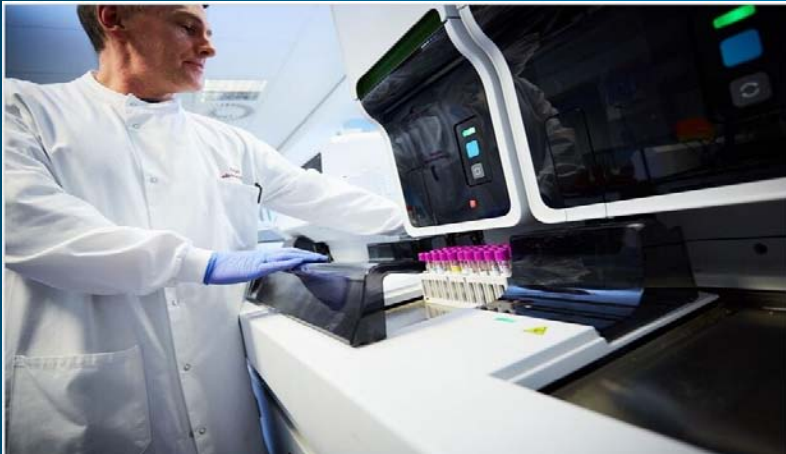

# 2016/17 Annual Review

## Effective

### *Challenges:*

- Scheduled Care
  - Treatment Time Guarantee
  - New Outpatient Waits
- Unscheduled Care
  - Accident and Emergency patients waiting less than four hours from arrival to treatment, admission, discharge or transfer



# 2016/17 Annual Review

## Effective

### *Challenges:*

- Cancer Waiting Times
  - 31 days from decision to treat to first treatment.
  - 62 days of urgent referral with a suspicion of cancer to treatment.



# 2016/17 Annual Review

## Looking Ahead

- We will continue:
  - To deliver and develop our services in partnership with those who use them
  - Our commitment to patient centred care
  - To address Inequalities
  - Integrating Adult Health and Social Care
  - Our work to achieve financial balance

# 2016/17 Annual Review

## Looking Ahead



# 2016/17 Annual Review

## Scottish Government

- **Shona Robison**  
*Cabinet Secretary for Health and Sport*
- **Paul Gray**  
*Director General Health and Social Care and Chief Executive NHS Scotland*
- **Alan Hunter**  
*Director of Performance and Delivery*
- **Christine McLaughlin**  
*Director for Health Finance*
- **Alison Taylor**  
*Head of Integration*

## NHS Greater Glasgow & Clyde

- **John Brown CBE**  
*Chairman*
- **Jane Grant**  
*Chief Executive*
- **Dr Jennifer Armstrong**  
*Medical Director*
- **Dr Margaret McGuire**  
*Nurse Director*
- **Mark White**  
*Finance Director*
- **Dr Linda de Caestecker**  
*Director of Public Health*